

DFD-150X series

Dynamic Rated FIRE DAMPERS with Sleeve

1 1/2 Hour Fire Resistance Rating

APPLICATION

Model DFD-150X is approved for use in walls, floors and partitions with fire resistance ratings less than 3 hours. This model carries a 1 1/2 hour UL fire damper label. UL 555 classifies dynamic rated fire dampers for use in HVAC systems that are operational in the event of fire.

RATINGS

UL555 Fire Resistance Rating

Fire Rating: 1 1/2 hours

Dynamic closure rating

Maximum Velocity: 4000 fpm (20.3 m/s) up to 24 in. x 24 in. (610mm x 610mm)
2000 fpm (10.2 m/s) above 24 in. x 24 in. (610mm x 610mm)

Maximum Pressure: 4 in. wg (1 kPa)

Model DFD-150X meets the requirements for fire dampers established by:

National Fire Protection Association
(NFPA Standards 80, 90A & 101)

IBC International Building Code

New York City (MEA listing #260-91-M)

California State Fire Marshall

(Listing #3225-981:102 for use in walls)

"UL CLASSIFIED (see complete marking on product)"

"UL CLASSIFIED to Canadian safety standards (see complete marking on product)"

Standard 555 (Listing #R13317)

Construction	Standard	Optional
Frame Material	Galvanized Steel*	-
Blade Material	Galvanized Steel*	-
Closure Spring	Stainless Steel	-
Fusible Link	165°F (74°C)	212°F or 286°F (100°C) or (141°C)
Mounting	Vertical	Horizontal

* in gauges required by UL listing R-13317

OPTIONAL FEATURES

- Security bars
- One piece retaining angles (POC)
- Transitions (B, C, CO, CR, & R)
- Steel stud connection
- Sealed transitions and sleeves

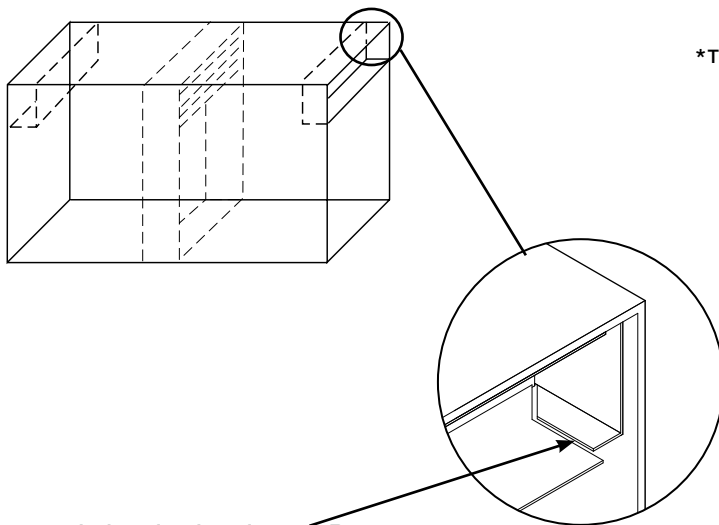

When sealed option is selected, B transitions will need to be field sealed in the area where duct to sleeve connection is made.

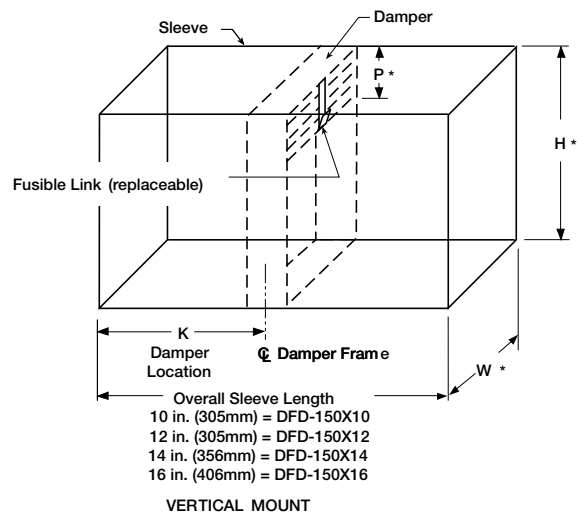

*These dimensions are furnished approximately 1/4 in. (6mm) undersize.

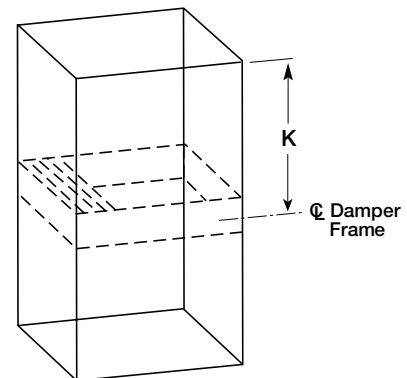

HORIZONTAL MOUNT

DFD-150X Type A & B

The following chart and illustrations show minimum and maximum damper section size.

SIZE LIMITATIONS

Inches (mm)	Type A		Type B	
	minimum	maximum	minimum	maximum
Single Section Vertical	6 x 4 (152 x 102)	36 x 36 (914 x 914)	6 x 6 (152 x 152)	36 x 31 (914 x 787)
Single Section Horizontal	6 x 4 (152 x 102)	30 x 30 (762 x 762)	6 x 6 (152 x 152)	30 x 26 (762 x 660)

Installation of sizes larger than the maximums shown requires approval of the authority having jurisdiction.

Type A Maximum Single Section Dimensions

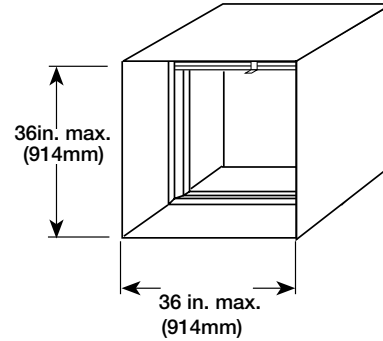

Type A

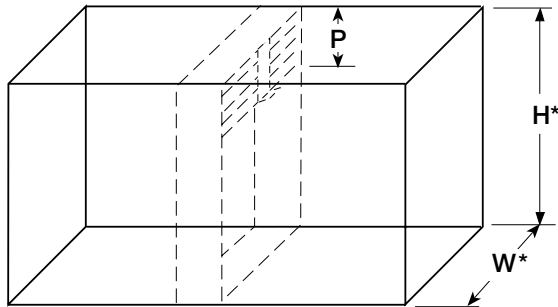

Type B Maximum Single Section Dimensions

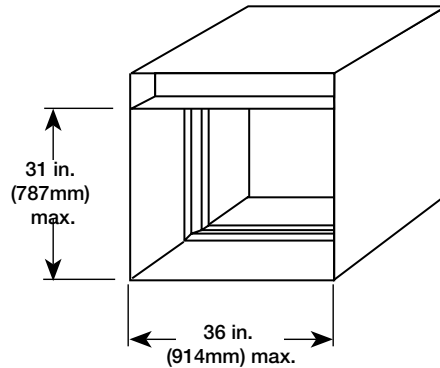

Type B Overall Damper Dimensions

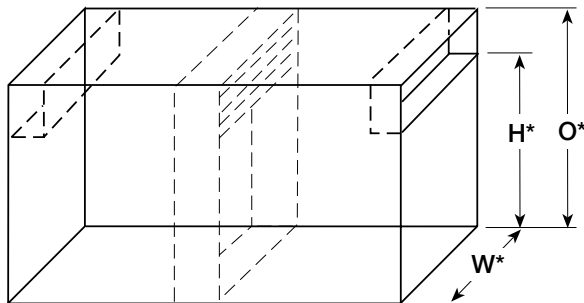

Vertical Mount

H*	O*	H*	O*
3 (76)	5 (127)	18 (457)	21 (533)
4 (102)	6 (152)	19 (483)	22 (559)
5 (127)	7 (178)	20 (508)	23 (584)
6 (152)	8 (203)	21 (533)	24 (610)
7 (178)	9 (229)	22 (559)	26 (660)
8 (203)	10 (254)	23 (584)	27 (686)
9 (229)	11 (279)	24 (610)	28 (711)
10 (254)	12 (305)	25 (635)	29 (737)
11 (279)	13 (330)	26 (660)	30 (762)
12 (305)	14 (356)	27 (686)	31 (787)
13 (330)	15 (381)	28 (711)	32 (813)
14 (356)	16 (406)	29 (737)	33 (838)
15 (381)	18 (457)	30 (762)	34 (864)
16 (406)	19 (483)	31 (787)	36 (914)
17 (432)	20 (508)		

Horizontal Mount

H*	O*	H*	O*
3 (76)	5 (127)	19 (483)	22 (559)
4 (102)	6 (152)	20 (508)	23 (584)
5 (127)	7 (178)	21 (533)	24 (610)
6 (152)	8 (203)	22 (559)	26 (660)
7 (178)	9 (229)	23 (584)	27 (686)
8 (203)	10 (254)	24 (610)	28 (711)
9 (229)	11 (279)	25 (635)	29 (737)
10 (254)	12 (305)	26 (660)	30 (762)
11 (279)	13 (330)	27 (686)	31 (787)
12 (305)	14 (356)	28 (711)	31 (787)
13 (330)	15 (381)	29 (737)	32 (813)
14 (356)	16 (406)	30 (762)	33 (838)
15 (381)	18 (457)	31 (787)	34 (864)
16 (406)	19 (483)	32 (813)	35 (889)
17 (432)	20 (508)	33 (838)	36 (914)
18 (457)	21 (533)		-

* These dimensions are furnished approximately 1/4 in. (6mm) undersize..

DFD-150X Types CR, CO & C

DFD-150X dampers with C, CO, CR, and R transitions are available only as single section dampers. The following chart show minimum and maximum damper size. Dimensions are in inches (mm in parentheses).

inches (mm)	Type CR		Type CO & C		Type R*1	
	Minimum	Maximum	Minimum	Maximum	Minimum	Maximum
Single section Vertical	3 (76)	30 (762)	3 x 3 (76 x 76)	34 x 30 (864 x 762)	3 (76)	34 (864)
Single Section Horizontal	3 (76)	25 (635)	3 x 3 (76 x 76)	28 x 25 (711 x 635)	3 (76)	28 (711)

*1 With 2 in. (50mm) offset. Sizes adjust with 0 offset & 1 in. (25mm) offset.

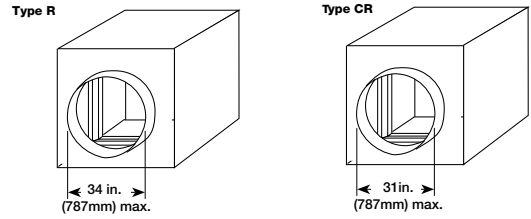

Steel Stud Connection (SSC) Option

The Steel Stud Connection (SSC) Option allows fastening of the damper sleeve (up to 36 in. W x 36 in. H [914mm x 914mm]) directly to the wall's steel stud framing. This option replaces the angles that were previously required for wall installations.

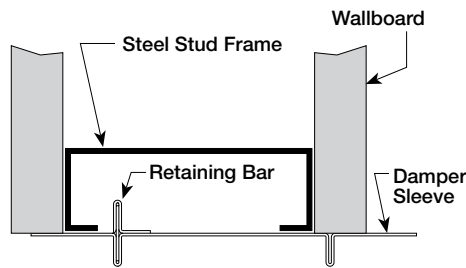
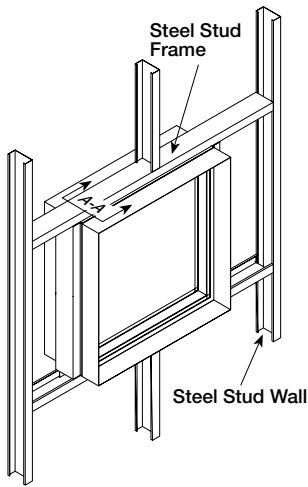

Cross-Section A-A

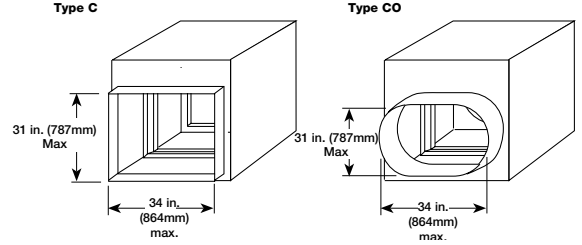

C, CO, CR transitions are positioned 1 in. (25mm) from bottom of sleeve.

Type C, CO & CR Overall Damper Dimensions

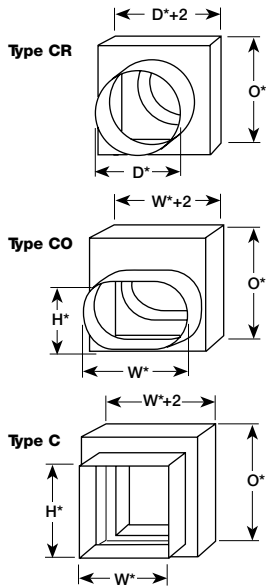

Vertical Mount

H* or D*	O*	H* or D*	O*
3 (76)	6 (152)	18 (457)	22 (559)
4 (102)	7 (178)	19 (483)	23 (584)
5 (127)	8 (203)	20 (508)	24 (610)
6 (152)	9 (229)	21 (533)	26 (660)
7 (178)	10 (254)	22 (559)	27 (686)
8 (203)	11 (279)	23 (584)	28 (711)
9 (229)	12 (305)	24 (610)	29 (737)
10 (254)	13 (330)	25 (635)	30 (762)
11 (279)	14 (356)	26 (660)	31 (787)
12 (305)	15 (381)	27 (686)	32 (813)
13 (330)	16 (406)	28 (711)	33 (838)
14 (356)	18 (457)	29 (737)	34 (864)
15 (381)	19 (483)	30 (762)	36 (914)
16 (406)	20 (508)		
17 (432)	21 (533)		

Horizontal Mount

H* or D*	O*	H* or D*	O*
3 (76)	6 (152)	18 (457)	22 (559)
4 (102)	7 (178)	19 (483)	23 (584)
5 (127)	8 (203)	20 (508)	24 (610)
6 (152)	9 (229)	21 (533)	26 (660)
7 (178)	10 (254)	22 (559)	27 (686)
8 (203)	11 (279)	23 (584)	28 (711)
9 (229)	12 (305)	24 (610)	29 (737)
10 (254)	13 (330)	25 (635)	30 (762)
11 (279)	14 (356)	26 (660)	31 (787)
12 (305)	15 (381)	27 (686)	31 (787)
13 (330)	16 (406)	28 (711)	32 (813)
14 (356)	18 (457)	29 (737)	33 (838)
15 (381)	19 (483)	30 (762)	34 (864)
16 (406)	20 (508)	31 (787)	35 (889)
17 (432)	21 (533)	32 (813)	36 (914)

* Dimension are in inches (mm). These dimensions are furnished approximately 1/4 in. (6mm) undersize.

