

**Belimo Actuator**

11-1FBC-1 Drive Arrangement

Explosion Proof

## Installation, Operation, and Maintenance Instructions

This manual is the property of the owner, and is required for future maintenance.  
Please leave it with the owner when the job is complete.

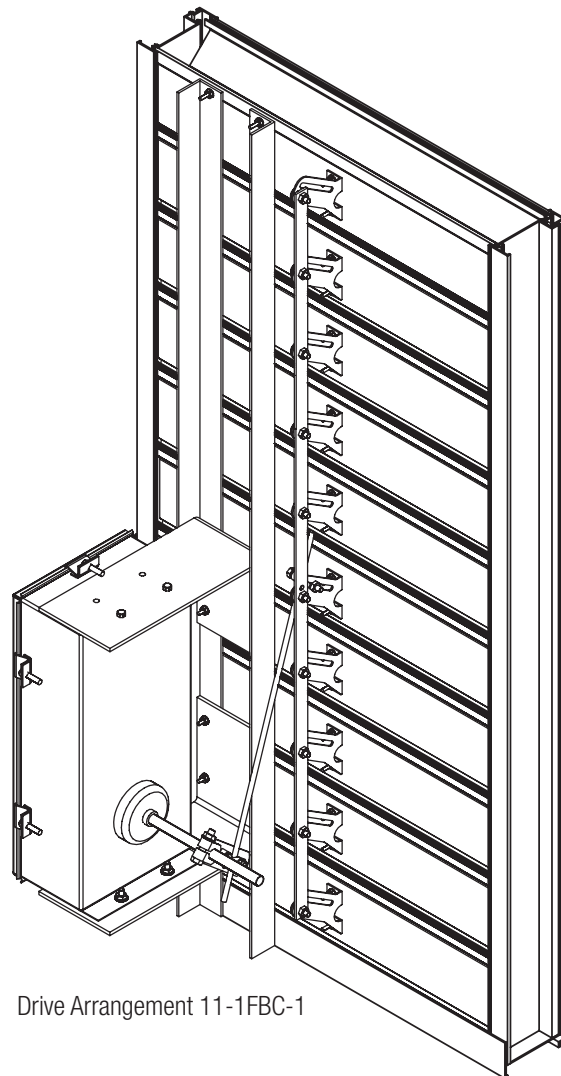

Drive Arrangement 11-1FBC-1

Note: This drawing depicts how the actuator looks after installation. The louver shown is intended to be a general representation and the actual louver model may vary. Reference the drawing on page 2 for an exploded view and parts list.

**SAFETY WARNING:**

**Improper installation, adjustment, alteration, service or maintenance can cause property damage, injury or death. Read the installation, operating, and maintenance instructions thoroughly before installing or servicing this equipment.**

### Prior to Adjusting

1. Louver MUST BE installed level and square for blades to operate correctly.
2. Install actuator and linkage similar to the drawing on page 1 and make the following linkage adjustments. Place ball swivel at initial location as show below. Adjust crankarm on the actuator so that it is parallel with linkage rod. If unit is "Fail Open" all adjustments will need to be made with the actuator in power on position

*Note: At this time the blades should flop freely.*

3. Loosen nut and bolt on actuator crankarm so that crank arm rotates freely by hand.

### Adjustment Process

*Note: Adjust actuators independently from each other if there is more than one actuator.*

1. With blades closed, rotate crankarm on actuator 1/8 turn toward louver from original starting point. Hold blade with ball swivel in closed position and tighten driver blade ball swivel to drive rod.
2. Rotate crankarm on actuator 1/8 turn back to original position. Tighten nut and bolt on crankarm. This will apply extra pressure to blade seals.

Caution: Before operating louver, make sure the ball swivel on the crankarm is in the correct location. If the blades are not completely closing, the ball swivel can be adjusted SLIGHTLY. An over adjustment can cause damage to the blades.

Caution: Before operating the louver, make sure the location of the ball swivel on the crankarm allows the proper travel length.

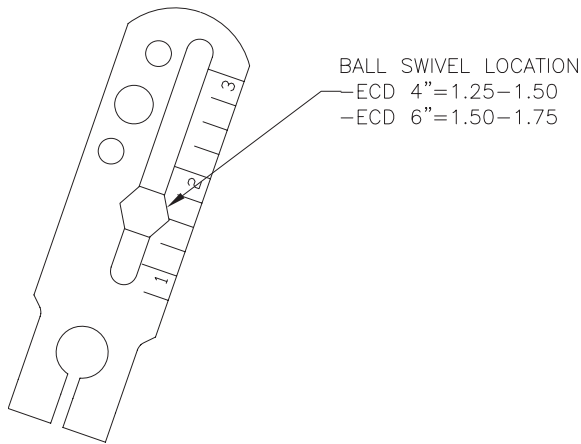
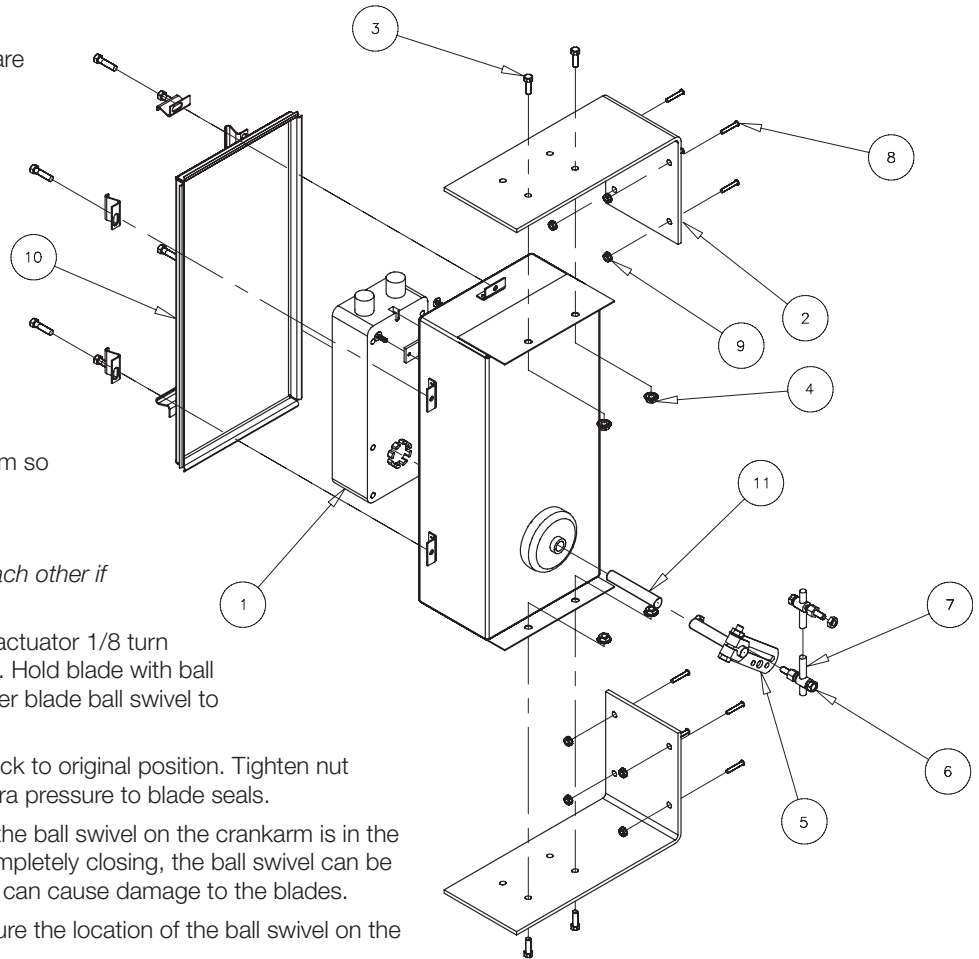

Item No.	Part No.	Qty.	Description
1A	381087	1 Required per Unit 1	Actuator AF-120
1B	381151		Actuator AF-120-S
1C	381598		Actuator AF-230
1D	381599		Actuator AF-230-S
1E	381085		Actuator AF-24
1F	381152		Actuator AF-24-S
1G	381150		Actuator AF-24-SR
1H	381600		Actuator AF-24-MFT
1J	381736		Actuator NF-24-SR
2	514140		2
3	415034	4	1/4-20x3/4 HH Zip MS
4	415455	4	1/4-20 HH Zip Nut
5	812097	1	Crankarm Assembly
6	451554	2	1/4" Ball Swivel
7	656473	1	16"x5/16 Galv. Rod
8	416052	8	10-32 Threadstud
9	415991	8	10-32 Hex Nut
10	459331	1	Nema 4x Enclosure Assembly
11	593832	1	1/2" Dia. Rod - 9.5"

It maybe necessary to adjust the swivel on the crankarm after the initial adjustments are made. This can be done by sliding the swivel in or out on the crankarm.

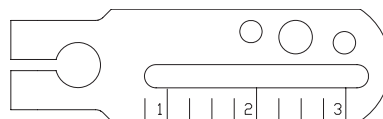

Sliding the swivel out on the crankarm will cause the blade to open more.

Sliding the swivel in on the crankarm will cause the blade to close more.