

These instructions explain how to replace double gland axle seals in the field. Axle (shaft) penetrations through frame are protected by double gland stuffing boxes. Tighten as required to prevent leakage around axle. Caution: Over tightening will create excessive frictional torque and rapid packing wear.

- 1) Replaceable packing material may deteriorate due to wear, oxidation or exposure to adverse chemicals. Replace as necessary. Greenheck provides a unique sealing construction with a two- piece packing clamp that splits to allow easy access to the packing material. See Figure 1
- 2) Remove 5/16"-18 nuts and stainless steel retaining clips. spread packing clamps and remove.
- 3) Remove old packing. In most installations, the packing cup can be pulled away from the damper frame to assist packing removal.

- 4) Cut replacement packing material on a 45° angle. Form into a ring.
- 5) Install the two rings (glands) of packing into cup, staggering the splices half turn apart. The removable cups have a ridge at the bottom to stop packing from passing through cup and to hold cup against damper frame.
- 6) Replace packing clamps against axle so they push against the packing.
- 7) Install stainless steel retaining clips and the two 5/16"-18 nuts. Tighten by hand. It is difficult to specify required tightening torque due to differences in axle diameters and packing materials but, packing should be below the top of the cup.

Stuffing Box Assembly

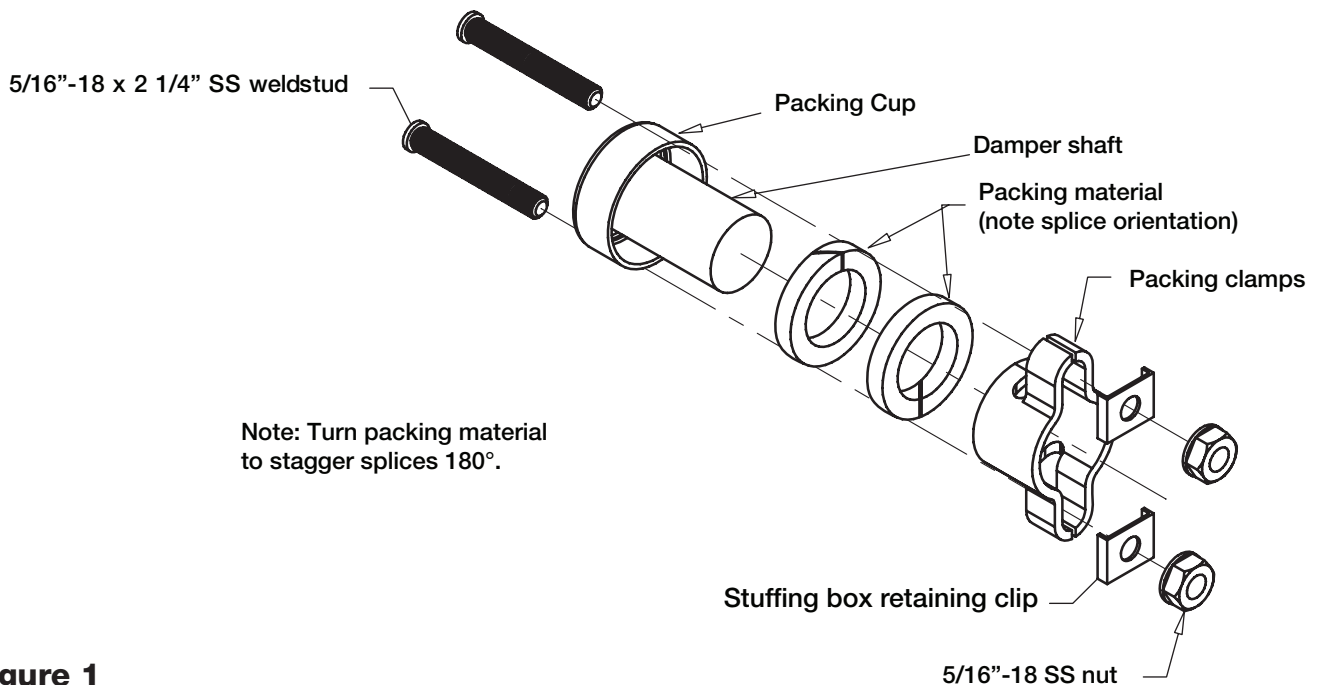

Figure 1