

# Pitch Protractor for Model AX

## Instructions:

- Follow Blade Pitch Adjustment Procedure as outlined in the AX High Performance Axial Installation, Operating and Maintenance Manual (Part #464664).
- Align protractor template edges to corresponding axes shown on Pitch Protractor (next page).
- Place leading edge of the blade on the protractor crosshair as shown. Identify current pitch by locating degree line the trailing edge lies on. (Example has 22° pitch).
- Adjust blade to desired angle while maintaining leading edge on the crosshair. This requires repositioning the pitch protractor.
- Use a marker to trace blade profile on Pitch Protractor or fan casing.
- Adjust remaining blades to the traced profile.
- Tighten blades as directed in the AX High Performance Axial Installation, Operating and Maintenance Manual (Part #464664).
- Remove Pitch Protractor from fan casing.

**Note:** The blade outline is for a counter-clockwise AX fan. Clockwise model blades have trailing edge of the blade at the crosshair and leading edge on degree line.

**Warning:** Pitch Protractor for Model AX must be printed at 100% on either 11x17 (Tabloid) or European Standard A3 paper size.

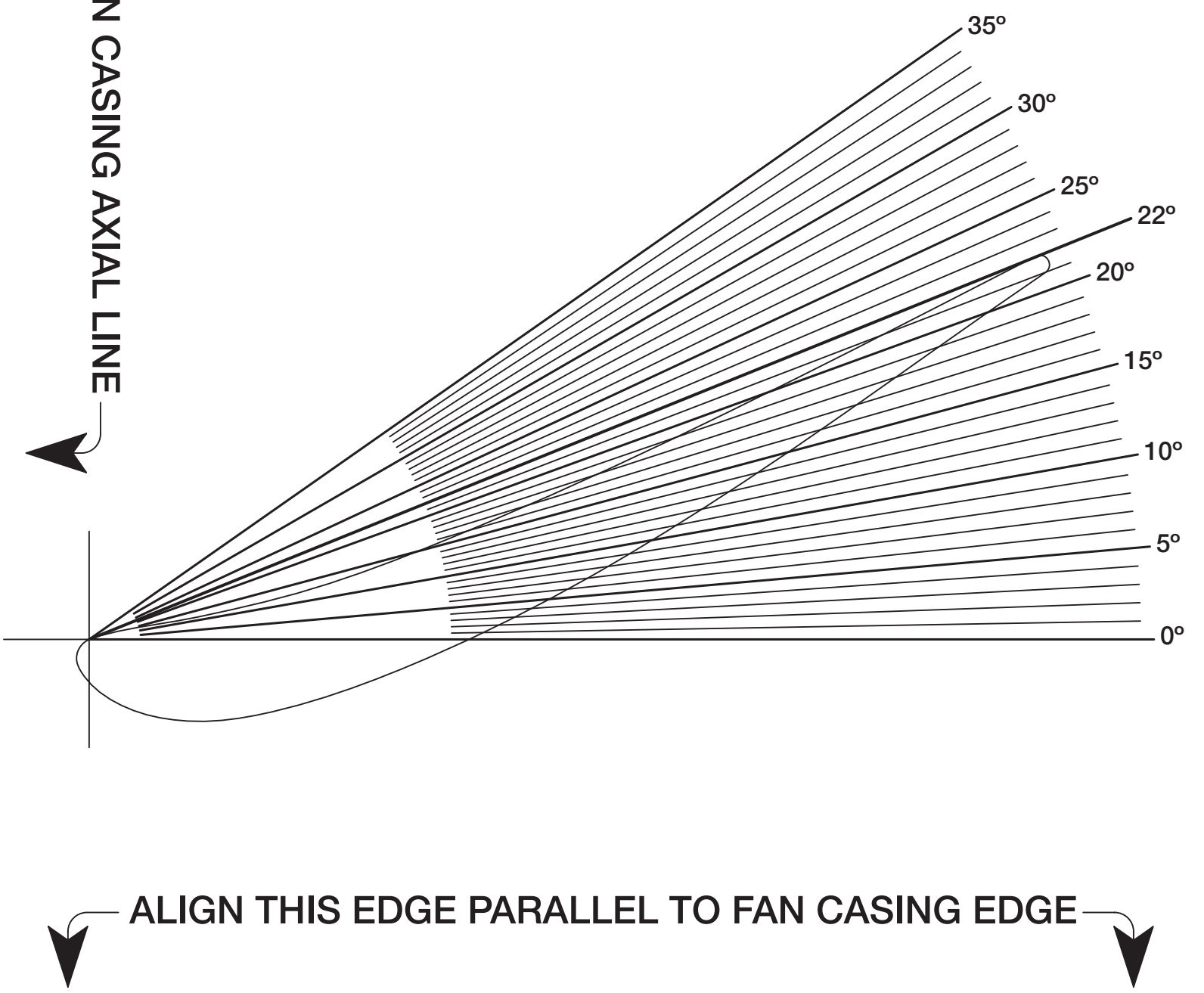

# Pitch Protractor for Model AX

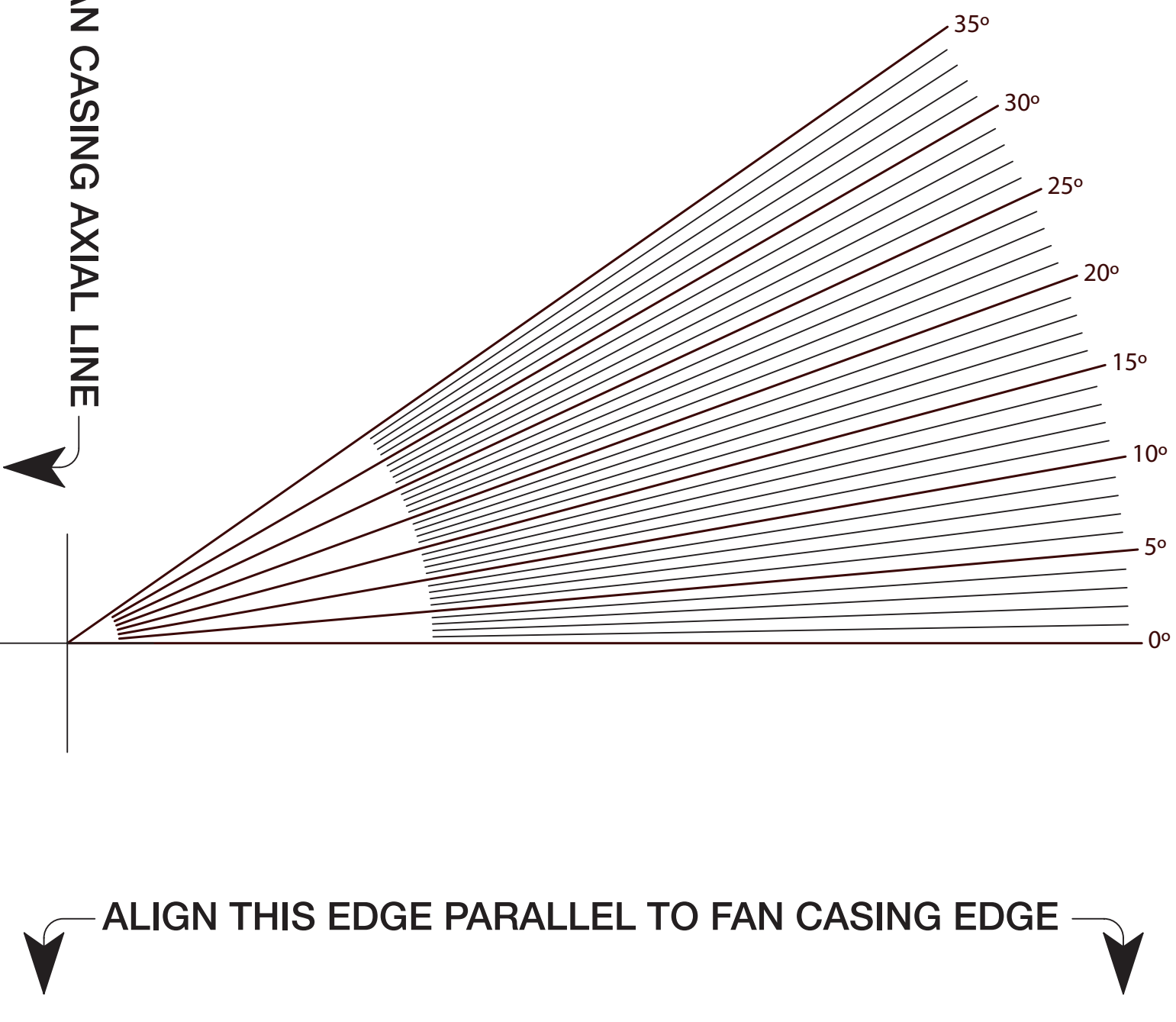
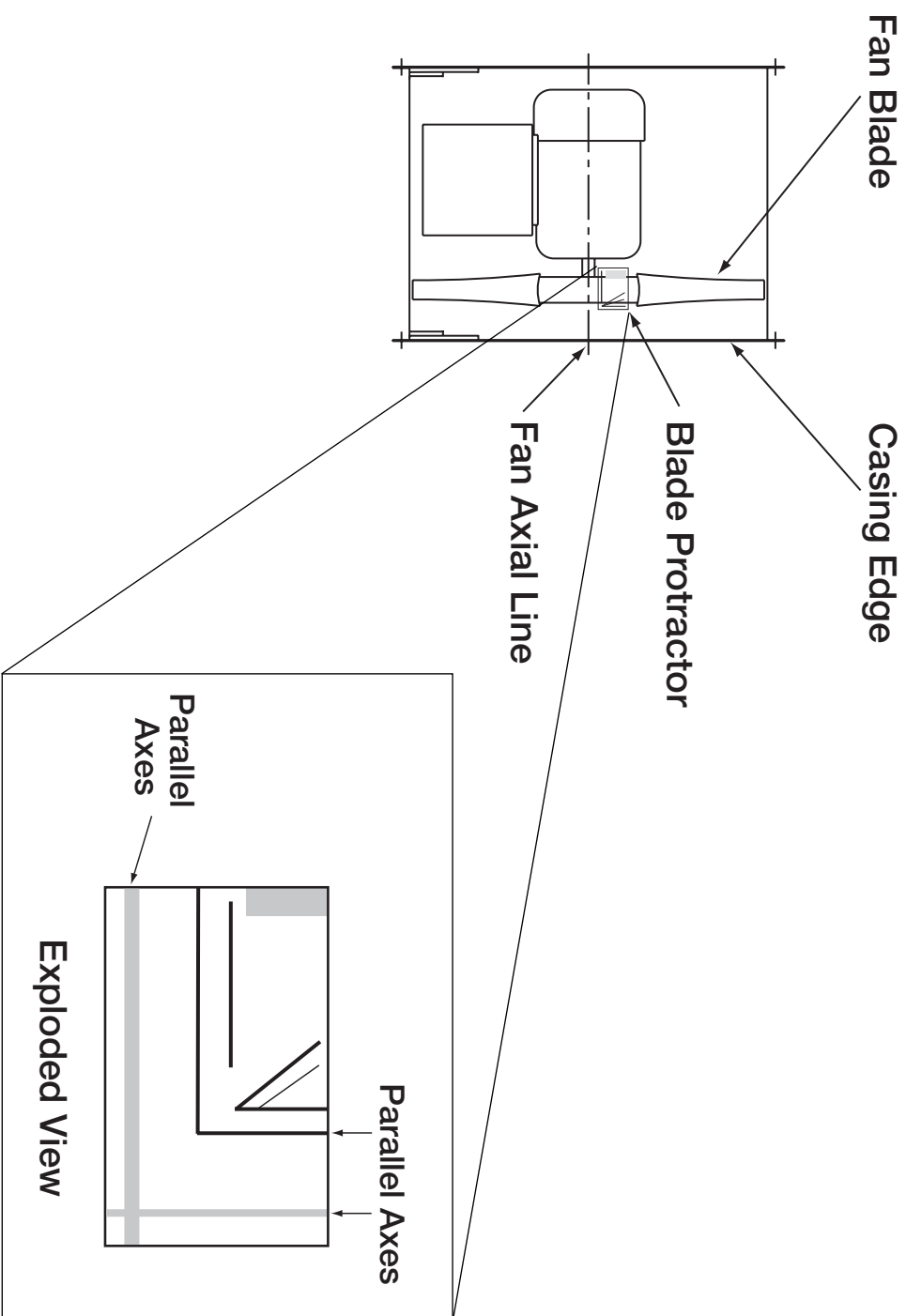

P.O. Box 410 • Schofield, WI 54476-0410 • 715.359.6171 • greenheck.com