



GREENHECK

Part Number 473694

Belimo AMB, FSLF, LMB, NMB and TF Actuators Mounted Internally

Installation Instructions

These instructions apply to the internal field replacement of the Belimo Series actuators on Greenheck VCD control damper models.

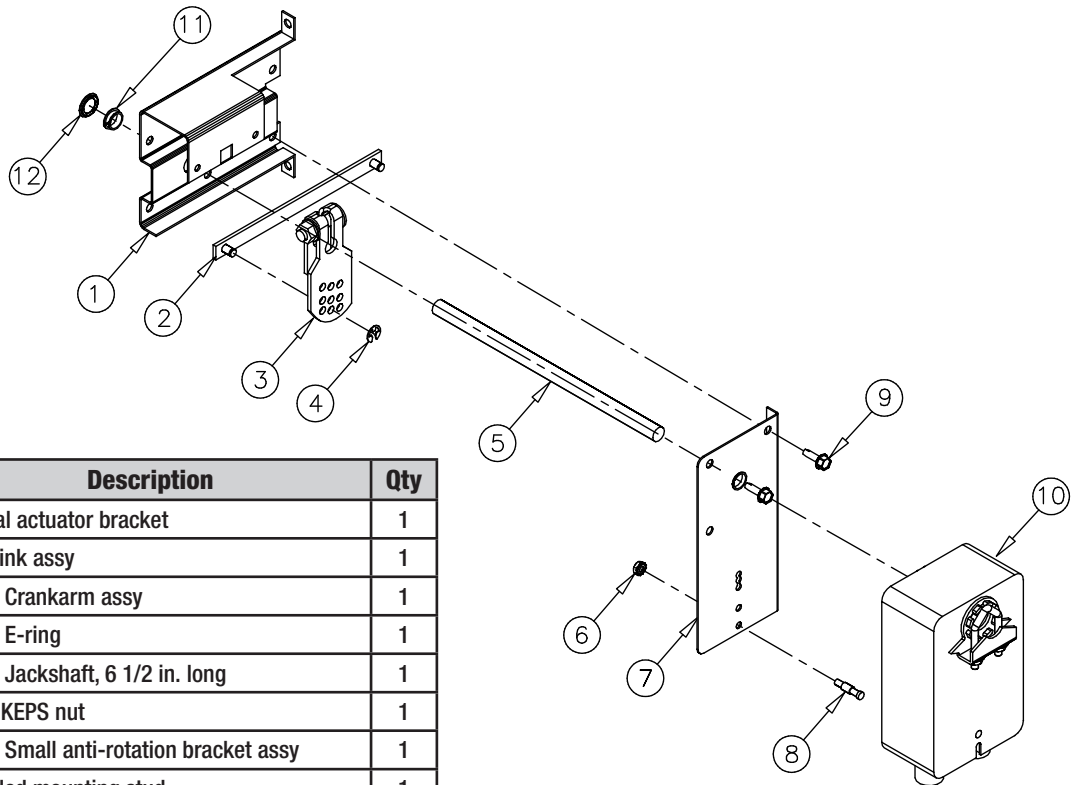

Item	Part No.	Description	Qty
1	723981	Internal actuator bracket	1
2	839475	Drive link assy	1
3	829206	1/2 in. Crankarm assy	1
4	451588	1/4 in. E-ring	1
5	593831	1/2 in. Jackshaft, 6 1/2 in. long	1
6	415385	10-32 KEPS nut	1
7	846551	1/2 in. Small anti-rotation bracket assy	1
8	416122	Threaded mounting stud	1
9	415264	1/4-20 x 1/2 TCS	2
10	-	Actuator	1
11	370159	1/2 in. Snap in bearing	1
12	416179	1/2 in. Retaining ring	1



WARNING

Equipment Damage or Electrical Power Hazard. Line voltage can cause death or serious injury and short equipment circuitry. Disconnect power supply before installation.



CAUTION

Device Malfunction Hazard. Improper set screw tightening causes device malfunction. Tighten set screws with proper torque to prevent damper shaft slippage.

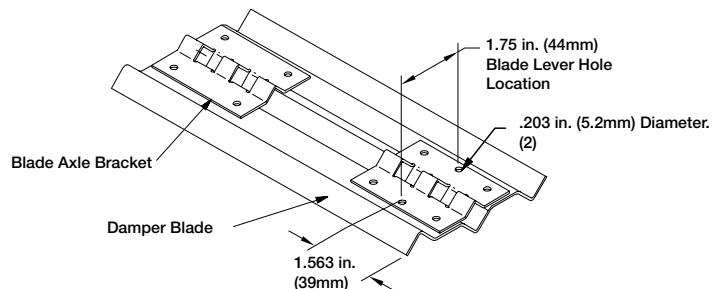

Detail A

Instructions

Belimo AMB, FSLF, LMB, NMB and TF Series

These installation instructions assume a damper is already mounted in a duct or sleeve. Have damper blades in the fail position.

1. Drill (2) .203 inch holes in the third blade from bottom, at location shown in *Detail A*.
2. Attach blade drive lever to blades using (2) 1/4 in. 20 x 1/2 in. thread cutting screws, self drilling screws or 1/4 in. - 20 x 1 1/4 in. bolts.
3. Fasten internal actuator bracket (item 1) to the left jamb of damper frame using (2) thread cutting screws and (2) 1/4 in. - thread studs with bolts through existing holes in jamb. Snap bearing (item 11) into the internal actuator bracket (item 1).
4. Snap bearing (item 11) into the anti-rotation bracket (item 7) and attach to the internal mount bracket (item 1) using [2] thread cutting screws (item 9).
5. Slide 1/2 in. diameter rod (item 5) slightly through the anti rotation bracket (item 7). Install crankarm (item 3) and drive link (item 2) onto the 1/2 in. diameter rod and (item 5) and install retaining ring (item 12) to lock drive link onto the internal actuator bracket (item 1).
6. Install threaded mounted stud (item 8) to the anti rotation bracket (item 7) using #10-32 Keps nut (item 6).
7. Attach actuator (item 10) to the anti-rotation bracket assembly (item 7). Tighten actuator onto shaft.
8. Connect drive link to blade drive lever using e-clip. With blades closed and the actuator in its fail position, position the blades in their fail position and tighten the crankarm to the 1/2 in. shaft.
9. Connect all electrical leads to the actuator. Apply power to the actuator. The damper blades should power position and return to the fail position when power is disconnected.

Model	Volts	Running	Holding
AMB24-3	24	2.5W	2.5W
AMB24-SR	24		
FSLF24	24	5VA	3.5VA
FSLF24-S	24		
FSLF120	120	18VA	6.5VA
FSLF120-S	120		
FSLF230	230	17VA	6VA
FSLF230-S	230		
LF24-SR	24	2.5W	1W
LF24-SR-S	24		
LMB24-3	24	1.5W	1.5W
LMB24-3-S	24		
LMB24-SR	24		
NMB24	24	2W	2W
NMB24-SR	24	2.5W	2.5W
TF24	24	2W	1.3W
TF24-S	24		
TF120	120	2.5W	1.3W
TF120-S	120		
TF24-SR	24	2W	1W
TF24-SR-S	24		

