



# Roof Curb and Duct Adapter

Model: APEX-200

## ASSEMBLY INSTRUCTIONS

### STEP 1: Unpack and Inspect Parts

Part Description	Qty	P/N	Length
<b>Roof Curb Kit</b>			
12 in. high	1	852212	
1. End Channel	2	708908	92.00 inches
2. Supply End Outer Channel	2	708909	42.75 inches
3. Supply End Inner Channel	2	708911	45.12 inches
4. Exhaust Side Channel	2	708912	72.87 inches
5. End Base Outer Channel	2	708914	61.25 inches
6. End Base Inner Channel	2	708913	57.00 inches
7. Center Channel	4	708910	92.00 inches
<b>Duct Adapter (12 in. high curb)</b>			
8. Adapter End Channel	3	711252	88.25 inches
9. Adapter Side Channel	4	711253	36.75 inches
<b>Hardware Kit (for curb &amp; duct adapter)</b>			
3/8-16 x 3/4 Serrated Flange Bolts	40	415459	
3/8-16 x 3/4 Serrated Flange Nuts	40	415457	
Screws, SMS (A) 12 x 0.625 (IHH)	35	415180	

### Tools Recommended for Assembly

- Cordless drill
- 5/16 in. Nut setter
- 9/16 in. Nut setter
- Open or Closed 9/16 in. wrench
- Awl — for hole alignment

## STEP 2: Assemble Duct Adapters

- Hardware Required:**
- (16) Screws, SMS (A) 12 x 0.625 (IHH)
  - (4) Adapter Side Channels
  - (3) Adapter End Channels
  - (1) Center Channel

- Instructions:**
- See **Exhaust and Supply Duct Adapter Assembly** for positioning the Adapter Side and End Channels.
  - Align the holes and fasten as shown.

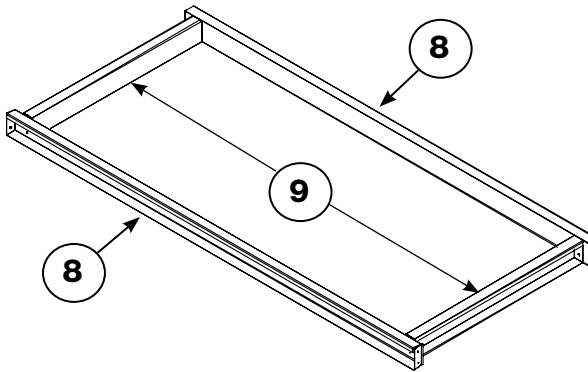

**Exhaust Duct Adapter Assembly**

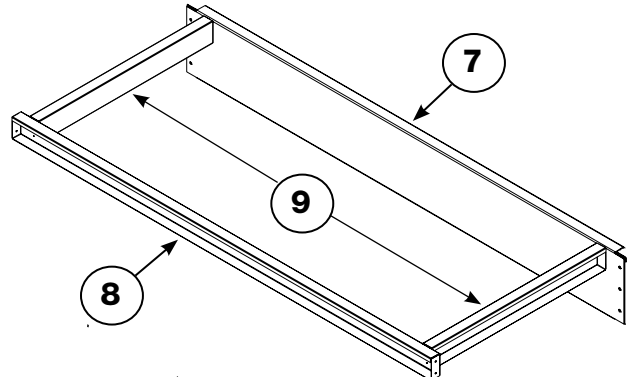

**Supply Duct Adapter Assembly**

## STEP 3: Assemble Supply End Section

- Hardware Required:**
- (12)  $\frac{3}{8}$ -16 x  $\frac{3}{4}$  Serrated Flange Bolts
  - (12)  $\frac{3}{8}$ -16 x  $\frac{3}{4}$  Serrated Flange Nuts
  - (4) Screws, SMS (A) 12 x 0.625 (IHH)
  - (1) End Channel
  - (2) Supply End Outer Channels
  - (2) Supply End Inner Channels
  - (1) Supply Duct Adapter Assembly (see Step 2)

- Instructions:**
- Position Channels as shown in **Supply End Assembly**
  - Align the holes and fasten as illustrated below.

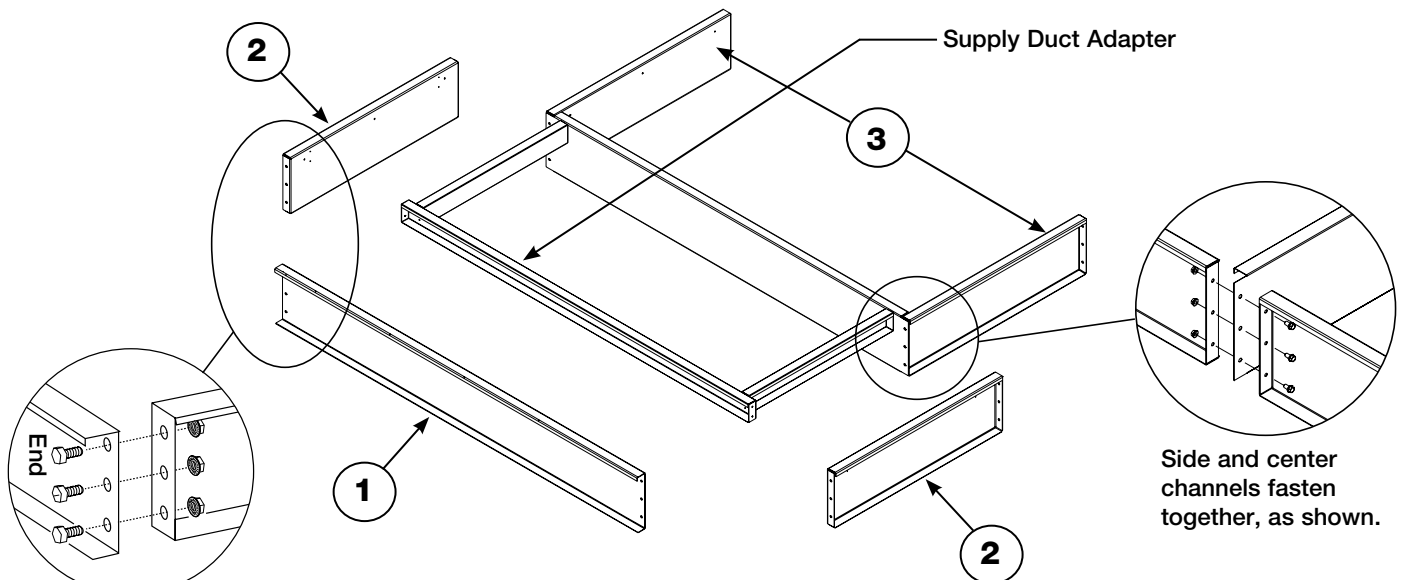

End and side channels fasten together, as shown.

**Supply End Assembly**

## STEP 4: Assemble Exhaust Center Section

- Hardware Required:**
- (1) Exhaust Duct Adapter
  - (2) Exhaust Side Channels
  - (8) Screws, SMS (A) 12 x 0.625 (IHH)

- Instructions:**
- See **Exhaust Center Assembly** for positioning the Exhaust Duct Adapter and Exhaust Side Channels.
  - Align the holes and fasten as shown.

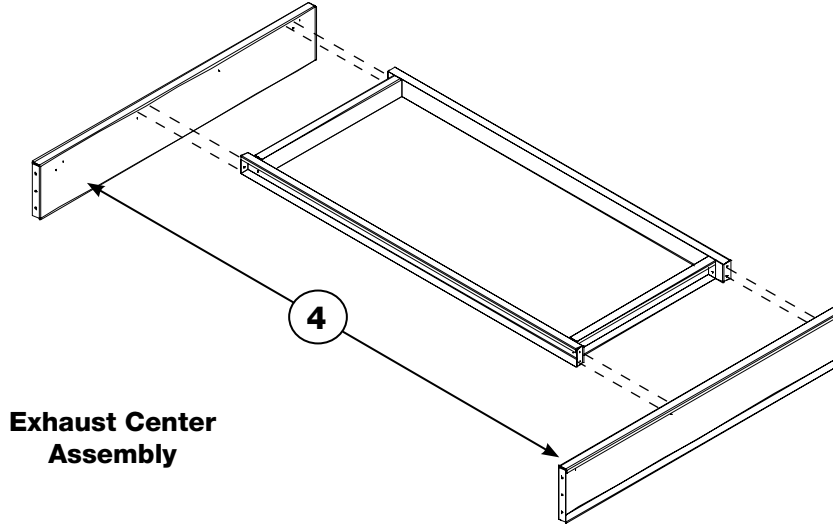

## STEP 5: Assemble End Base Section

- Hardware Required:**
- (18)  $\frac{3}{8}$ -16 x  $\frac{3}{4}$  Serrated Flange Bolts
  - (18)  $\frac{3}{8}$ -16 x  $\frac{3}{4}$  Serrated Flange Nuts
  - (1) End Channel
  - (2) End Base Outer Channels
  - (2) End Base Inner Channels
  - (2) Center Channels
  - (1) Exhaust Center Section (see Step 4)

- Instructions:**
- Position Channels as shown in **Exhaust Center and End Base Assembly**
  - Align the holes and fasten as illustrated below.

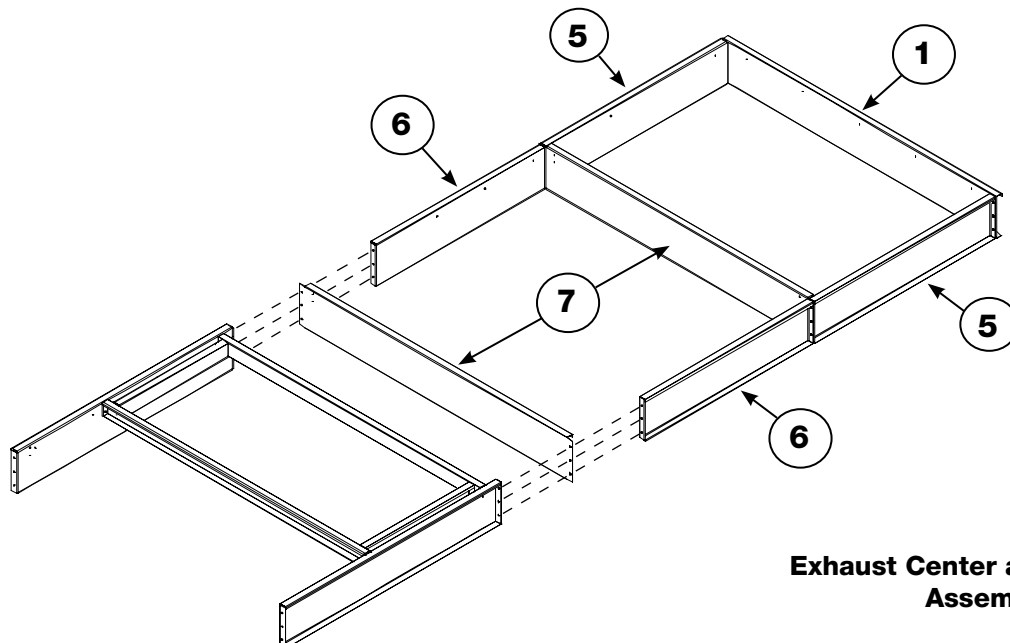

## STEP 6: Final Assembly

- Hardware Required:**
- (6)  $\frac{3}{8}$ -16 x  $\frac{3}{4}$  Serrated Flange Bolts
  - (6)  $\frac{3}{8}$ -16 x  $\frac{3}{4}$  Serrated Flange Nuts
  - (1) Center Channel
  - (1) Exhaust Center and End Base Assembly (see Step 5)
  - (1) Supply End Section (see Step 3)

- Instructions:**
- Position Channels as shown in **Final Assembly**
  - Align the holes and fasten as illustrated below.

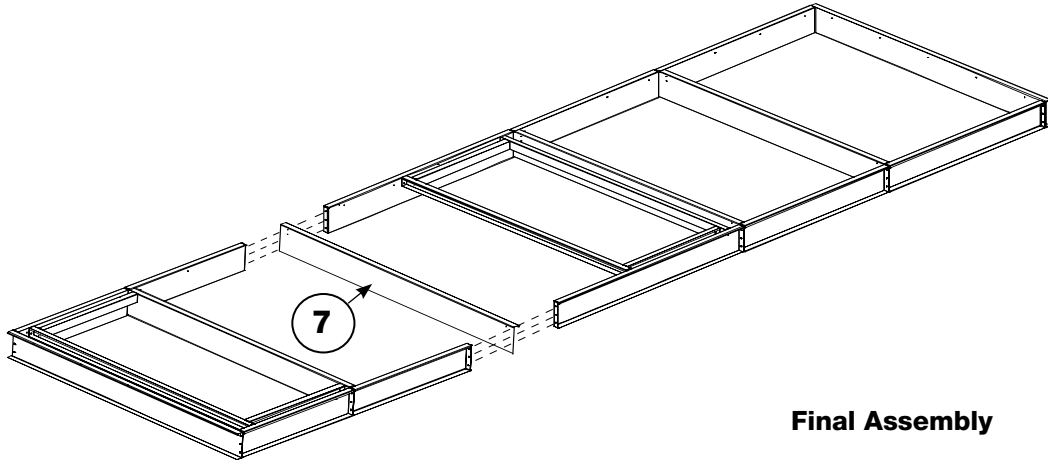

**Final Assembly**

## Curb Dimensions

